

# BSGAR CONFERENCE

FEBRUARY 4-6 2015 | THE QUEENS HOTEL | LEEDS

## 17th ANNUAL MEETING PROGRAMME

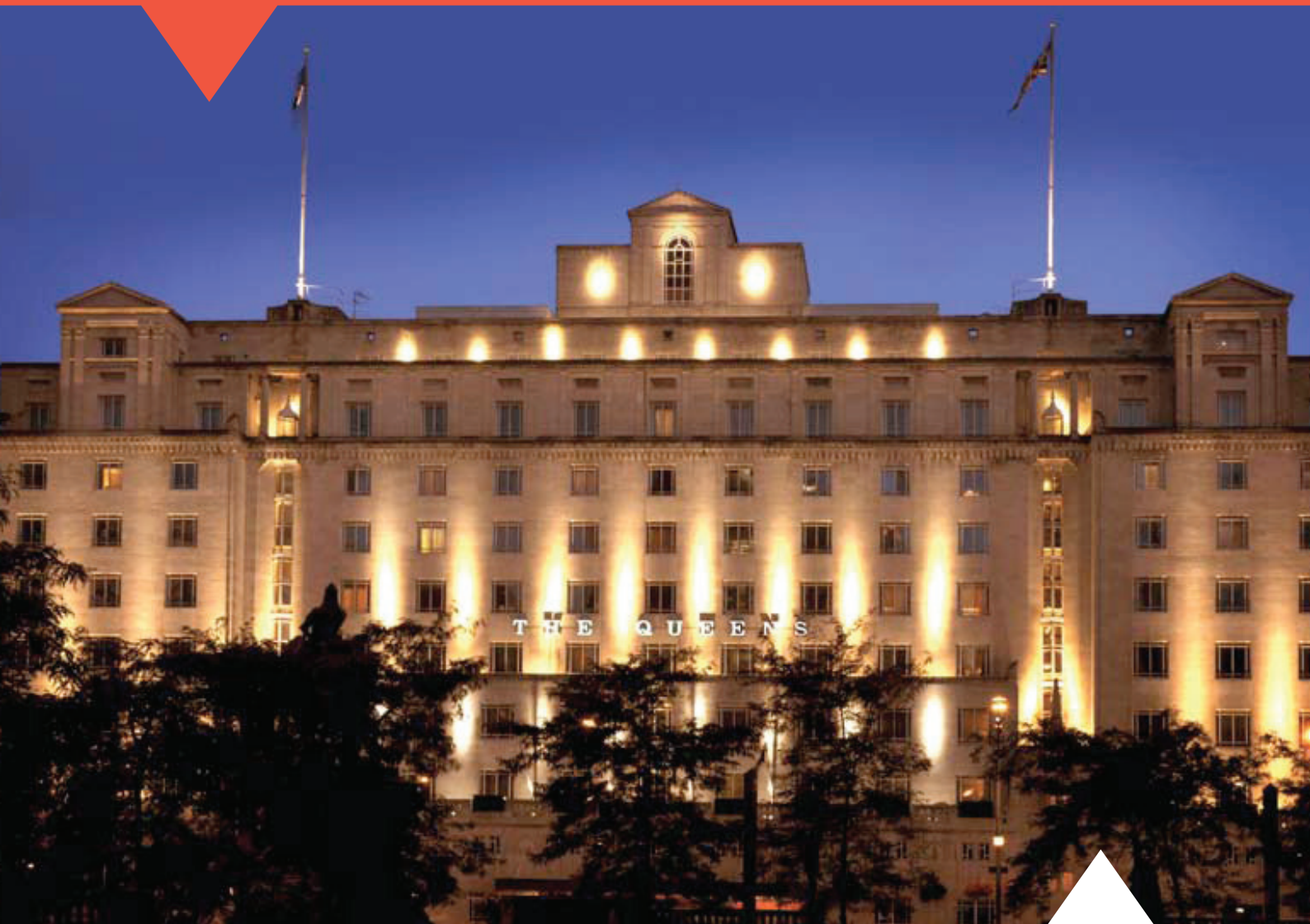

**British Society of  
Gastrointestinal &  
Abdominal Radiology**

Imaging, Intervention and  
Research in the care of  
patients with abdominal  
disease

12 RCR CPD Credits have been  
awarded for the annual meeting

6 RCR CPD Credits have been awarded  
for the Small Bowel MRI Workshop

# PROGRAMME CONTENTS

<b>PRESIDENT'S WELCOME</b>	<b>3</b>
<b>MEETING PROGRAMME</b>	<b>4-5</b>
<b>SPONSORS</b>	<b>6</b>
<b>FLOOR PLAN</b>	<b>7</b>
<b>SOCIAL PROGRAMME</b>	<b>8</b>
<b>BECOME A BSGAR MEMBER</b>	<b>9</b>
<b>DELEGATE LIST</b>	<b>10-13</b>
<b>DELEGATE PACK CONTENTS</b>	<b>14</b>
<b>BSGAR 2016</b>	<b>15</b>



# BSGAR COMMITTEE

<b>PRESIDENT</b>	Dr Ashley Guthrie	<b>EDUCATION OFFICER</b>	Dr Edmund Godfrey
<b>SECRETARY</b>	Dr Delia Peppercorn	<b>STANDARDS OFFICER</b>	Dr Stuart Williams
<b>TREASURER</b>	Dr Andrew Thrower	<b>BSGAR JUNIOR REPRESENTATIVE</b>	Dr Dushyant Shetty
<b>RESEARCH OFFICER</b>	Dr Arun Gupta	<b>BSGAR ADMINISTRATOR</b>	Liz Jones
<b>AUDIT OFFICER</b>	Dr Tony Higginson		

# BSGAR PRESIDENT'S WELCOME

Dear Colleagues

On behalf of the Management Committee, it is my pleasure to welcome the British Society of Gastrointestinal and Abdominal Radiology back to Leeds for the third time. As the society continues to grow, there is the enviable challenge of finding suitable venues, having outgrown old favourites. On this occasion, we are located in the Art Deco elegance of the Queens Hotel, in the city centre. The dinner is being held across City Square at Aspire, on the site of the original Infirmary in Leeds, before its relocation to Great George Street in 1868.

I hope the programme contains something for everyone, with GI and abdominal topics approached from a variety of clinical, technical and analytical angles. The small bowel MRI workshop is being run for the second time and has again proved very popular, filling within days of the opening of registration.

The theme of the first afternoon relates to our wider responsibilities in our duty of care to patients. One of the topics within this session, and one that the profession is still adjusting to, is the Francis Report, and I am grateful to Mr Peter Walsh (Chief Executive of Action against Medical Accidents), who attended the enquiry in full, for giving his perspective.

The current president of the Royal College of Radiologists, Dr Giles Maskell, is not only a GI Radiologist, but also a former colleague of Richard Farrow, so it seems doubly fitting that he is delivering the annual Memorial Lecture.

The second day opens with the "Interesting Cases" session and, as usual, there will be prizes for the best presentations. However, the prize for the best case presented by a trainee will now be entitled the "Derrick Martin prize" in honour of the first President (then Chairman) of BSGAR (then SIGGAR), who has contributed much to our sub-speciality and inspired many to become GI radiologists.

I would like to thank all those who have generously contributed their time and energy to the organisation and delivery of this, the 17th BSGAR Annual Meeting, and for the support of our sponsors which helps keep the costs manageable.



DR ASHLEY GUTHRIE  
BSGAR President



# MEETING PROGRAMME

## Wednesday 4th February 2015

- 09.00-16.00 Small Bowel Symposium
- 18.30-20.00 Welcome Reception - Palm Court  
at The Queens Hotel

## Thursday 5th February 2015

- 08.45 WELCOME  
*Dr A Guthrie (Leeds Teaching Hospitals)*
- 08.50-11.00 SESSION ONE**  
**STAGE 4 COLORECTAL CANCER  
- PUSHING THE BOUNDARIES**  
*Chair - Dr D Tolan (Leeds Teaching Hospitals)*
- 08.50 PERITONEAL DISEASE & SURGERY  
*Dr A Thrower / Mr F Mohamed  
(Basingstoke & North Hampshire Hospital)*
- 09.20 PELVIC RECURRENT DISEASE  
*Dr D Tolan / Professor P Sagar  
(Leeds Teaching Hospitals)*
- 09.50 LIVER METASTASES  
*Dr A Guthrie / Professor P Lodge  
(Leeds Teaching Hospitals)*
- 10.15 PULMONARY METASTASES  
*Mr R Milton (Leeds Teaching Hospitals)*
- 10.30 MDT  
*Professor M Seymour (Clinical Research Director,  
NCRI) and all the above speakers*
- 11.00-11.30 COFFEE
- 11.30-12.30 SESSION TWO**  
**OFF THE FENCE - WHEN TO  
GET THE KNIFE OUT...**  
*Chair - Dr A Higginson  
(Portsmouth Hospitals NHS Trust)*
- 11.30 ABDOMINAL TRAUMA  
*Dr S Upponi (Addenbrookes Hospital)*
- 11.50 THE ACUTE ABDOMEN  
*Dr A Plumb (UCLH)*

## Thursday 5th February 2015

- 12.10 THE POST-OPERATIVE ABDOMEN  
*Dr J Brittenden (Pinderfields Hospital)*
- 12.30 PANEL DISCUSSION (20 MIN)  
CASES – WEBSITE
- 12.50-14.00 LUNCH
- 14.00-15.30 SESSION THREE**  
**COMPLAINTS, CANDOUR  
AND THE COUNCIL**  
*Chair - Professor C Kay  
(Bradford Teaching Hospitals)*
- 14.00 "I WISH TO REGISTER A COMPLAINT"  
*Mr J P Garside  
(Norfolk & Norwich University Hospitals)*
- 14.25 THE FRANCIS REPORT -  
IMPLICATIONS FOR RADIOLOGISTS  
AND RADIOLOGY DEPARTMENTS  
*Mr P Walsh, Chief Executive,  
Action Against Medical Accidents (AvMA)*
- 14.50 THE RADIOLOGIST AND THE GMC  
*Dr U Nandasoma  
(MDU & Consultant Hepatologist)*
- 15.15 DISCUSSION
- 15.30-16.15 TEA
- 16.15-17.00 SESSION FOUR**  
**RICHARD FARROW  
MEMORIAL LECTURE**  
*Dr G Maskell  
(President of Royal College of Radiologists)*
- 17.00 BSGAR AGM
- 19.30 DRINKS RECEPTION AT ASPIRE
- 20.00 DINNER AT ASPIRE

## Friday 6th February 2015

08.45-09.45 INTERESTING CASES  
*Chair - Dr E Godfrey (Addenbrookes Hospital)*

**09.45-11.00 SESSION ONE**  
**HOW LOW CAN YOU GO?**  
*Chair - Dr A Thrower*  
*(Basingstoke & North Hampshire Hospital)*

09.45 SURVEILLANCE FOR  
COLORECTAL CANCER  
*Mr J Griffith (Bradford Royal Infirmary)*

10.05 ABDOMINAL RADIATION DOSE  
*Professor M Maher*  
*(University College Hospital Cork)*

10.25 CONTRAST FOR ABDOMINAL CT  
(Optimising contrast delivery)  
*Dr B Rajashanker*  
*(Manchester Royal Infirmary)*

10.45 DISCUSSION

11.00-11.25 COFFEE

11.25-11.30 PRIZES

11.30-11.50 BSGAR TRIALS AND AUDIT

**11.50-13.00 SESSION TWO**  
**LUMPS** Critical Analysis of  
Masses arising outside the  
major solid and hollow  
organs  
*Chair - Dr D Peppercorn*  
*(North Hampshire Hospital)*

11.50 RETROPERITONEAL LUMPS  
*Dr C Messiou (The Royal Marsden, London)*

12.10 MESENTERIC LUMPS  
*Dr R Hyland (Leeds Teaching Hospitals)*

12.30 SARCOMA SURGERY  
*Mr K Horgan (Leeds Teaching Hospitals)*

12.50 DISCUSSION

## Friday 6th February 2015

13.00-14.00 LUNCH

13.15 30 MINUTE SYMPOSIUM BY BAYER  
Imaging of colorectal cancer  
liver metastases from a surgical  
perspective  
*Professor E Jonas*  
*(Karolinska University Hospital, Stockholm)*

**14.00-16.00 SESSION THREE**  
**EVALUATION OF GI RADIOLOGICAL  
SIGNS - HOW DO I EVALUATE...**  
*Chair - Dr S Williams*  
*(Norfolk & Norwich University Hospitals)*

THE HYPERVASCULAR LIVER  
LESION  
*Dr B Simpson*  
*(Norfolk & Norwich University Hospitals)*

THICKENED SMALL BOWEL  
*Dr I Zealley (Ninewells Hospital)*

THICKENED LARGE BOWEL  
*Dr D Burling (St Marks Hospital, London)*

THE CYSTIC PANCREATIC LESION  
*Dr R Albazaz (Leeds Teaching Hospitals)*

FOCAL THICKENING OF THE  
GALLBLADDER  
*Dr A Higginson*  
*(Portsmouth Hospitals NHS Trust)*

MESENTERIC WHORLS  
*Professor S Sukumar*  
*(University Hospital South Manchester)*

THE MISTY MESENTERY  
*Professor M Maher*  
*(University College Hospital Cork)*

**16.00 CLOSE**  
*Dr A Guthrie*



# SPONSORS

BSGAR would like to thank its sponsors for their generous support of this meeting. Funding by sponsors, which is used towards towards exhibition space and the cost of the educational

component of this meeting, is provided with no input or influence regarding the content of the scientific sessions. We would especially like to thank our main sponsor, Bayer, for generously providing funding and the 30 minute symposium by Professor Eduard Jonas, Karolinska University Hospital, Stockholm, on Friday lunchtime.



## Sponsor Attendees

**BAYER**  
Steve Broadhurst  
Jane Fearnley Gleaves  
Suzanne Jarvis

**BIRMINGHAM CLINICAL TRIALS**  
James Brown  
Manjinder Kaur

**BRACCO**  
Lisa Hodge  
Eddie Klarich

**BVM**  
Alan Atkinson  
Eddie Mahon

**CAREFUSION**  
Robert Bardsley  
Richard Fearn

**COOK**  
Marie McKinnon  
Sarah Robertshaw  
Julie Romaines

**GUERBET**  
Pierre Couture  
Lech Guzowski

**HITACHI**  
Jonathan Clode  
Kurt Lauriers

**MANATECH**  
Chris Bolter  
Asif Hajiani  
Scott Kearton  
Kishen Prang

**MERMAID MEDICAL**  
Robin Crossley  
Andrew Maxwell

**SANOCHEMIA**  
Denis Underwood

# FLOOR PLAN

## The Lobby

Ground Floor

Stairs to Ark Royal Foyer

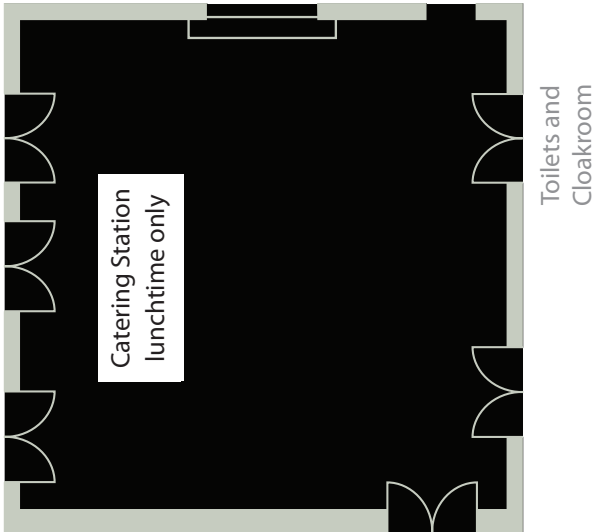

## Ark Royal

To Bedroom Corridor

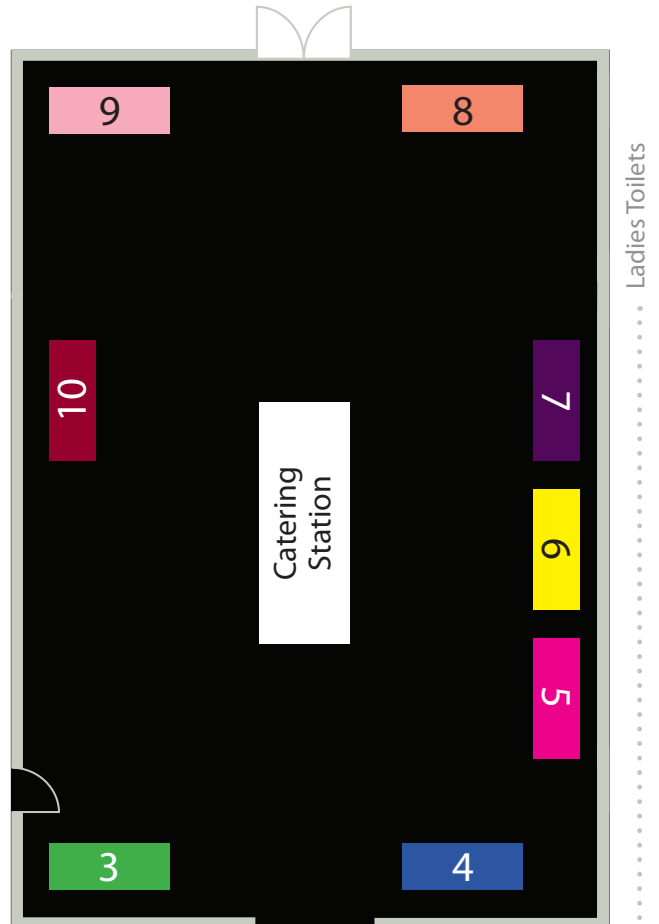

### Exhibitor Stands & Key Code

- Stand 1 Bayer
  - Stand 2 Bayer
  - Stand 3 Guerbet
  - Stand 4 Sanochemia
  - Stand 5 Bracco
  - Stand 6 Hitachi
  - Stand 7 Carefusion
  - Stand 8 BVM
  - Stand 9 Cook
  - Stand 10 Manatech
  - Stand 11 Mermaid Medical
  - Stand 12 Birmingham Clinical Trials
- 
- Creative Conferences Desk
  - BSGAR Secretariat Desk

Door to Lecture Theatre (Ballroom) leads to

- Stand 12
- BSGAR Secretariat Desk

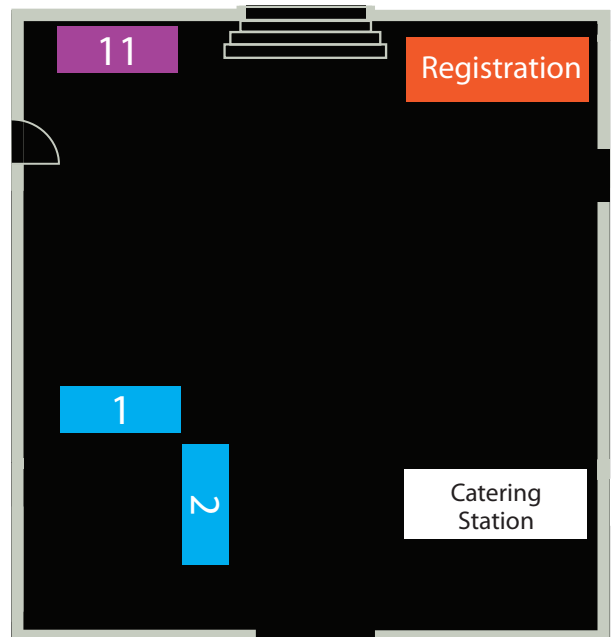

Stairs to Ground Floor  
Ark Royal Foyer

# SOCIAL PROGRAMME

## Wednesday 4th February 2015

18.30-20.00 Welcome Reception  
Palm Court at The Queens Hotel



## Thursday 5th February 2015

19.30-20.15 Drinks Reception  
20.15 Course Dinner at Aspire

Entertainment for the course  
dinner will be provided by  
The Chris White Jazz Trio.





# BECOME A BSGAR MEMBER



The following types of Membership to the British Society of GI and Abdominal Radiology (BSGAR) are available:

## **FULL MEMBERSHIP AND JUNIOR MEMBERSHIP**

Full membership is open, by application to the executive committee to all practising or retired radiologists in the UK who have a special interest in Gastrointestinal and Abdominal radiology. Junior membership is open to specialist registrars training in the UK, interested in GI radiology. All full and junior members have voting rights at the Annual General Meeting. The yearly membership fee is £50 to help cover administrative expenses. Members are eligible for reduced registration fees at the BSGAR Annual Meeting.

## **ASSOCIATE MEMBERSHIP**

Associate membership is open, by application to the executive committee to any radiographer with a significant role in GI and Abdominal Radiography who wishes to take an interest in the group's activities. Associate members do not have voting rights at the Annual General Meeting but have full access to all members' only sections of the BSGAR website. We wish to have active communications with all our professional colleagues, and encourage interaction in support of the Society's interests and the activities of its' full and junior members.

The yearly membership fee is £25 to help cover administrative expenses.

## **HONORARY MEMBERSHIP**

Honorary membership may be awarded to BSGAR full members who are considered to have made a significant contribution to GI and Abdominal Radiology through their clinical practice, teaching and research. Individual members can submit suggestions for honorary membership to the management committee. The management committee will consider such requests and submit the names of suitable candidates for ratification, by a simple majority, to the Annual General Meeting.

Applications can be made online at [www.bsgar.org](http://www.bsgar.org)

Alternatively you can speak to Liz Jones or Dr Delia Peppercorn at this meeting.

# DELEGATE LIST

## A

**DR ADEL ABDELLAOUI**  
Derriford Hospital

**DR RAMEEN ALBAZAZ**  
Leeds Teaching Hospitals

**DR ROSEMARY ALLEN**  
St. George's Hospital

**DR ZAHIR AMIN**  
University College  
Hospital London

**DR JUDITH ANDERSON**  
Royal Edinburgh  
Infirmary

**DR KIRSTY ANDERSON**  
Freeman Hospital

**DR DAVID ATKINSON**  
Aquilant Interventional

**DR GOHAR AYUB**  
Leeds Teaching Hospitals

## B

**DR SHARIFAH BAKAR**  
Serdang Hospital

**DR R  
BALASHANMUGAM**  
Manchester Royal  
Infirmary

**DR NAUMAN BARLAS**  
Wansbeck General  
Hospital

**DR TARA BARTON**  
Worcestershire Royal  
Hospital

**DR CHRISTINE  
BAUDOIN**  
Newcastle-Upon-Tyne  
Hospitals

**DR ANDY BAXTER**  
Worcestershire Royal  
Hospital

**DR HELEN BELCHER**  
Royal Cornwall Hospital

**DR MARY JANE BENNIE**  
Norfolk & Norwich  
Univesity Hospital

**DR MAGGIE BETTS**  
Oxford University  
Hospitals

**DR GAURAANG  
BHATNAGAR**  
University College  
Hospital London

**DR TONY  
BLAKEBOROUGH**  
Sheffield Teaching  
Hospitals

**DR DOMINIC BLUNT**  
Charing Cross Hospital

**DR DAVID BOWDEN**  
Sunnybrook Health  
Sciences Centre, Canada

**DR KAREN BRADSHAW**  
Birmingham Childrens'  
Hospital

**DR JENNIFER BRAID**  
Worcestershire Acute  
Hospitals Trust

**DR ROBERT BRIGGS**  
Huddersfield Royal  
Infirmary

**DR JOHN BRITTENDEN**  
Mid Yorkshire NHS Trust

**DR INGRID BRITTON**  
University Hospital  
of North Staffs

**DR DAVID BURLING**  
St. Mark's Hospital

**DR JAMES BURN**  
Charing Cross Hospital

**DR BRIONY BURNS**  
Western Sussex NHS  
Trust Chichester

**DR DAVID BRUCE**  
Leicester General  
Hospital

## C

**DR MARK CALLAWAY**  
Bristol Royal Infirmary

**DR SHONA CAMPBELL**  
University College  
Hospital London

**DR KEITH WANG  
HANG CHIU**  
Hull & East Yorkshire  
Hospitals NHS Trust

**DR CHRISTOPHER  
CLARKE**  
Nottingham University  
Hospitals NHS Trust

**DR AMY CLAYTON**  
University Hospital  
of Wales

**DR CONOR CORR**  
Wrexham Maelor  
Hospital

**DR SUSAN COX**  
Royal Preston Hospital

**ADAM  
CULVERWELL**  
Harrogate NHS  
Foundation Trust

## D

**DR H D'COSTA**  
Oxford University  
Hospitals

**DR TRUPTI  
DABHOLKER**  
Leighton Hospital

**DR MARK DAVIES**  
City Hospital Birmingham

**DR REBECCA DE  
NORONHA**  
Sheffield Teaching  
Hospitals

**DR SHARAD DESAI**  
Royal Albert Edward  
Infirmary

**DR RAJPAL DHINGSA**  
Nottingham University  
Hospital NHS Trust

**DR MAJULA  
DURAIWAMY**  
Southampton General  
Hospital

## E

**DR DONNA EDWARDS**  
Hairmyres Hospital

**DR RIM ELIAS**  
Rotherham NHS  
Foundation Trust

**DR JULIAN ELFORD**  
Royal Hampshire County  
Hospital

**DR RUTH ENGLAND**  
Leeds Teaching Hospitals

**DR SARAH EVANS**  
Kingston Hospital

**DR ANGHARAD EYNON**  
University Hospitals  
Wales, Cardiff

## F

**DR NEIL FAIRLIE**  
Northampton General  
Hospital

**DR DAVID FLEMING**  
Royal Gwent Hospital

**DR BRUCE FOX**  
Derriford Hospital

## G

**DR SANJAY GANDHI**  
Southmead Hospital

**MR JOHN-PAUL  
GARSIDE**  
Norfolk and Norwich  
University Hospital

**DR LAURA GELLETT**  
Royal Devon and Exeter  
Hospital

**DR SUNETHRA  
GHATTAMANENI**  
Salford Royal Hospital

**DR MAURICE GIBSON**  
Cheltenham General  
Hospital

**DR KANWAR GILL**  
Mid Yorkshire Hospitals  
NHS Trust

**DR STEPHEN GLANCY**  
Western General Hospital

**DR EDMUND GODFREY**  
Addenbrookes Hospital

**DR FRANK GOLLUB**  
Epsom & St. Helier  
University Hospitals NHS  
Trust

**DR LESLEY  
GOMERSALL**  
Aberdeen Royal Infirmary

**DR JAMES GRAHAM**  
Royal Victoria Infirmary  
Newcastle-Upon-Tyne

**DR KAREN GRAY**  
Hairmyres Hospital

**DR CATHERINE  
GRIERSON**  
University Hospital  
Southampton

**MR JOHN GRIFFITH**  
Bradford Royal Infirmary

## G

**DR NIGEL GRUNSHAW**  
Furness General Hospital

**DR ARUN GUPTA**  
St. Marks Hospital

**DR SARAH GURNEY**  
Calderdale &  
Huddersfield NHS Trust

**DR ASHLEY GUTHRIE**  
Leeds Teaching Hospitals

**DR CATHERINE GUTTERIDGE**  
Plymouth Hospital NHS  
Trust

## H

**DR WASIM HAKIM**  
St. Mary's Hospital

**PROFESSOR STEVE HALLIGAN**  
University College  
Hospital London

**DR SIMON HARRIES**  
Royal Devon & Exeter  
Hospital

**DR HUSSEIN HASSAN**  
Grimsby Hospital

**DR LOUISE HATTINGH**  
Bradford Teaching  
Hospitals

**DR PRIYA HEALEY**  
Royal Liverpool  
University Hospital

**DR NICK HEDLEY**  
University Hospital  
of Wales

**DR NIKLAS HENNESSY**  
Royal Bournemouth  
Hospital

**DR ERYL HICKS**  
Royal Glamorgan  
Hospital

**DR TONY HIGGINSON**  
Portsmouth Hospitals  
NHS Trust

**DR DAVID HODGSON**  
Blackpool Victoria  
Hospital

**DR ROB HOLMES**  
Royal Victoria Infirmary

**MR KIERAN HORGAN**  
Leeds Teaching Hospitals

**DR SASHA HOUGHTON**  
Maidstone Hospital

**DR JUDITH HOWARD**  
Bassetlaw and Doncaster

**DR NICK HUGHES**  
Frimley Park Hospital

**DR PENG HUI-LEE**  
Mid Essex Hospitals

**DR RACHEL HYLAND**  
Leeds Teaching Hospitals

## I

**DR AAMER IFTIKHAR**  
Leeds Teaching Hospitals

**DR LIAM INGRAM**  
University Hospital  
Southampton

## J

**DR SIMON JACKSON**  
Derriford Hospital

**NAEEM JAGIRDAR**  
Bradford Royal Infirmary

**DR ALEX JANUSZ**  
Aberdeen Royal Infirmary

**DR CRAIG JOBLING**  
Nottingham University  
Hospitals NHS Trust

**PROFESSOR EDUARD JONAS**  
Karolinska University  
Hospital, Stockholm

**DR RICHARD JONES**  
Northampton General  
Hospital

## K

**DR MATHEW KADUTHODIL**  
Doncaster and Bassetlaw  
NHS Trust

**DR DINA KASIR**  
Salford Royal Hospital

**PROFESSOR CLIVE KAY**  
Bradford Teaching  
Hospitals

**DR TOM KAYE**  
Leeds Teaching Hospitals

**DR PETER KENNEDY**  
Royal Victoria Hospital

**DR STUART KERR**  
Mid Yorkshire NHS Trust

**DR CATE KEY**  
Northern General  
Hospital, Sheffield

**DR MIRIAM KHALIL**  
Epsom & St. Helier  
University Hospitals  
NHS Trust

**DR SHAHID KHAN**  
Queen Elizabeth 2nd  
Hospital

**DR AMAN KHARAY**  
Northwich Park and  
St. Mark's Hospital

**DR E NANDA KUMAR**  
Royal Blackburn Hospital

## L

**DR HANNAH LAMBIE**  
Leeds Teaching Hospitals

**DR CHARLIE LANE**  
University Southampton  
Hospital

**DR SNEHAL LAPSIA**  
Royal Blackburn Hospital

**DR ISABEL LAURENCE**  
Southmead Hospital

**DR KATHRYN LAWRENCE**  
Dorset County Hospital

**DR STEPHEN LEE**  
Manchester Royal  
Infirmary

**DR SONALI LIMDI**  
Fairfield General Hospital

**DR SUE YIN LIONG**  
University Hospital of  
South Manchester

**PROFESSOR PETER LODGE**  
Leeds Teaching Hospitals

**DR MONG-YANG LOH**  
Stepping Hill Hospital

## M

**DR MALCOLM MACFARLANE**  
West Suffolk Hospital

**DR JODY MACLACHLAN**  
Royal Free London

**DR RACHEL MAGENNIS**  
University Hospital South  
Manchester

**PROFESSOR MICHAEL MAHER**  
University College  
Hospital, Cork

**DR RICHARD MANNION**  
York Teaching Hospitals  
NHS Trust

**DR KAREN MASON**  
Gloucestershire Royal  
Hospitals

**DR SHAUN MCGEE**  
Salisbury District Hospital

**DR MICHELLE MCMAHON**  
Leeds Teaching Hospitals

**DR GILES MASKELL**  
Royal Cornwall Hospital

**DR ALISTAIR MATTHEWS**  
Queen Margaret Hospital  
NHS Fife

**DR COLIN MEANOCK**  
Royal Berkshire Hospital

**DR SUNIL MEHTA**  
Stockport Foundation  
Trust

**DR YOUSSEF MENTIAS**  
Sunderland Royal  
Hospital

**DR CHRISTINA MESSIUO**  
The Royal Marsden,  
London

**DR CLAIRE MILLER**  
Birmingham Childrens'  
Hospital

**MR RICHARD MILTON**  
Leeds Teaching Hospitals

**DR NAHEED MIR**  
Royal Free London NHS  
Trust

**DR AMJAD MOHAMMED**  
Bradford Royal Infirmary

**DR FAHIZ MOHAMMED**  
Basingstoke & North  
Hampshire Hospital

# DELEGATE LIST

## M

**DR SHRUTI MOHOLKAR**

Birmingham Childrens' Hospital

**DR IAIN MORRISON**

Kent and Canterbury Hospital

**DR JOHN MORRISON**

Southern General Hospital Glasgow

## N

**DR KATHERINE NAIK**

Pinderfield Hospital

**DR YACOOB NAKHUDA**

East Lancashire NHS Trust

**DR UDVITHA NANDASOMA**

MDU Services

**DR MYLES NELSON**

Antrim Area Hospital

**DR REHAAN NENSEY**

Sandwell General Hospital

**DR PHYLLIS NSIAH-SARBENG**

Royal Free Hospital

## O

**DR CATHERINE O'DWYER**

Salford Royal Hospital

**DR SARAH O'SHEA**

Manchester Royal Infirmary

**DR RWTH OWEN**

University Hospital Wales, Cardiff

## P

**DR ALISON PAGE**

Queen Elizabeth Hospital Birmingham

**DR DEEPAK PAI**

Scunthorpe General Hospital

**DR BALAN PALANIAPPAN**

Royal Glamorgan Hospital

**DR ARVIND PALLAN**

Queen Elizabeth Hospital Birmingham

**DR PHILIP PANTO**

King's Mill Hospital

**DR CRAIG PARRY**

University Hospital of Wales Cardiff

**DR DELIA PEPPERCORN**

North Hampshire Hospital

**DR DAN PETTY**

York Teaching Hospitals NHS Trust

**DR ANDREA PHILLIPS**

Royal United Hospital Bath

**DR CAROL PHILLIPS**

Bristol Royal Infirmary

**DR KATIE PLANCHE**

Royal Free Hospital

**DR ANDREW PLUMB**

University College Hospital London

## Q

**DR MANSOORUL QAIYM**

Newcross Hospital

## R

**DR VEENA RAO**

University Hospital of North Tees & Hartlepool NHS Trust

**DR SIAN ROBBINS**

Shrewsbury & Telford NHS Trust

**DR ASHLEY ROBERTS**

University Hospital Wales, Cardiff

**DR CATHERINE ROBERTS**

Huddersfield Royal Infirmary

**DR CHARLOTTE ROBINSON**

Royal Berkshire Hospital Reading

**DR MARK ROBINSON**

Royal Gwent Hospital

**DR VELAUTHAN RUDRALINGAM**

South Manchester NHS Trust

**DR SUZANNE RYAN**

King's College Hospital

## S

**PROFESSOR PETER SAGAR**

Leeds Teaching Hospitals

**DR LOKESH SARASWAT**

Freeman Hospital

**DR JOHN SCOTT**

Freeman Hospital

**DR MATTHEW SCOTT**

Royal Victoria Infirmary

**PROFESSOR MATT SEYMOUR**

Clinical Research Director of NCRI

**DR NEHAL SHAH**

Hampshire Hospitals Foundation Trust

**DR VIKAS SHAH**

Leicester Royal Infirmary

**DR DUSH SHETTY**

Royal Cornwall Hospital

**DR PHILIP SHORVON**

London North West Healthcare

**DR HARBIR SIDHU**

UCL Centre Medical Imaging & UCLH

**DR BEN SIMPSON**

Norfolk & Norwich University Hospitals

**DR SHRILAY SINHA**

Calderdale & Huddersfield Foundation Trust

**DR ANDREW SLATER**

John Radcliffe Hospital

**DR KIRSTY SLAVEN**

St. Helens' and Knowsley NHS Trust

**DR DAVID STEELE**

Wishaw General Hospital

**DR JAMES STEPHENSON**

Leicester General Hospital

**DR ROBERT STOCKWELL**

Chorley & South Ribble District General Hospital

**DR TIM STONE**

Royal Shrewsbury Hospital

**DR JACK STRAITON**

Aberdeen Royal Infirmary

**DR MADELINE STRUGNELL**

Royal Cornwall Hospital

**PROFESSOR SATHI SUKUMAR**

University Hospital South Manchester

## T

**DR MOHAMMED ALI TABREZ**

Dorset County Hospital

**DR DEBORAH TATTERSALL**

Queen Elizabeth Hospital Birmingham

**DR ALASDAIR TAYLOR**

NHS Highland

**DR HELENA TAYLOR**

Royal Hampshire County Hospital

**DR JOHN TAYLOR**

Weston General Hospital

**DR RICHARD TAYLOR**

Norfolk & Norwich University Hospitals

**DR STUART TAYLOR**

University College Hospital London

**DR BIJU THOMAS**

Royal Stoke University Hospital

**DR CENYDD THOMAS**

Yeovil District Hospital

**DR RICHARD THOMAS**

Royal Devon & Exeter Hospital

**DR ELEN THOMSON**

Leeds Teaching Hospitals

## T

### DR ANDREW THROWER

Basingstoke & North  
Hampshire Hospital

### DR PETER THURLEY

Royal Derby Hospital

### DR MANI THYAGARAJAN

Birmingham Childrens'  
Hospital NHS Foundation  
Trust

### DR GRACE TIMMONS

Queen Elizabeth Hospital  
Gateshead

### DR RICHARD TIPPETT

Dorset County Hospital

### DR DAMIAN TOLAN

Leeds Teaching Hospitals

### DR NEAL TOWNSEND

Salford Royal Hospital

### DR PHILIP TRAVIS

Glan Clwyd Hospital

### DR ANNE TURNBULL

Royal Derby Hospital

### DR CAROLYN TWEED

Northern General  
Hospital

### DR MARK TWEMLOW

North Tyneside General  
Hospital

## U

### DR UMESH UDESHI

Worcestershire Acute  
Hospitals Trust

### DR SARA UPPONI

Addenbrookes Hospital

### DR KEN UZOKA

Pennine Acute Hospitals  
NHS Trust

## V

### DR KEVIN VALLANCE

George Eliot Hospital

### DR KATHERINE VAN REE

Imperial NHS Trust

### DR CLAUDIO VENTURI

Countess of Chester  
Hospital

### DR RAGU VINAYAGAM

Sheffield Teaching  
Hospitals

### DR VIDHIYA VINAYAKAMOORTHY

City Hospital Nottingham  
University Hospitals

## W

### DR SHARAN WADHANI

Worcestershire Royal  
Hospital

### MR PETER WALSH

Chief Executive of Action  
Against Medical  
Accidents

### DR DAVID WHITE

Radiology Reporting  
Online

### DR MARK WHITE

Airedale NHS  
Foundation Trust

### DR SIOBHAN WHITLEY

Cambridge University  
Hospitals

### DR DAVID WIDDOWSON

Glan Clwyd Hospital

### DR SUE WILDE

Queen Elizabeth Hospital  
King's Lynn

### DR MICHAEL WILLIAMS

Derriford Hospital

### DR STUART WILLIAMS

Norfolk & Norwich  
University Hospitals

### DR MARGARET WILKINSON

Northumbria Healthcare

### DR MARK WILLS

Salisbury District Hospital

### DR LORNA WOODBIDGE

Royal Free Hospital

### DR HELEN WOODLEY

Leeds Children's Hospital

### DR PHILIP WOOLFALL

University Hospital of  
North Tees

## Y

### DR ALISON YATES

University Hospital  
Wales, Cardiff

### DR AUDREY YONG

Velindre Cancer Centre

### DR WINDSOR TUDOR YOUNG

Princess Wales Hospital

## Z

### DR SHAMAS ZAMAN

Stoke Mandeville  
Hospital

### DR IAN ZEALLEY

Ninewells Hospital  
Dundee





# DELEGATE PACK CONTENTS

Included in your delegate packs are the following:

## - PROGRAMME BOOKLET



## - SPONSOR VISITING CARDS

Give these to sponsors when visiting their stand and you will be put into a prize draw for a John Lewis voucher.



## - COURSE DINNER TICKET

(only if pre-booked)



## - BSGAR MEMBERS DATABASE FORM

BSGAR are looking to update their database and would appreciate you completing the form for their records



## - EVALUATION FORM

This must be handed in to Creative Conferences before leaving in order to receive your CPD certificate. All certificates will be sent out electronically by end of February 2015.







WE ARE DELIGHTED TO ANNOUNCE THE 18TH ANNUAL  
BSGAR MEETING WILL BE HELD AT THE ICC IN BIRMINGHAM.

The meeting will take place on 3rd - 5th February 2016.

Registration will be available online at  
[www.creativeconferences.co.uk](http://www.creativeconferences.co.uk) from September 1st 2015.

**BOOKMARK YOUR DIARY NOW!**



Creative Conferences has had the pleasure of organising the BSGAR Annual Meetings since the inception of SIGGAR in 1999. We hope we'll see you next year in Birmingham.

Creative Conferences, 11 Wicker Lane, Hale Barnes, Altrincham, WA15 0HG  
Tel/Fax 0161 980 8180 | [creativeconferences@btinternet.com](mailto:creativeconferences@btinternet.com) | [www.ukcreativeconferences.com](http://www.ukcreativeconferences.com)



**British Society of  
Gastrointestinal &  
Abdominal Radiology**

Imaging, Intervention and  
Research in the care of  
patients with abdominal  
disease

[www.BSGAR.org](http://www.BSGAR.org)